

HISTORY of DAEYOUNG PRECISION CO.

- 1999** 06. Company established
10. Permitted to manufacture medical instruments(No.773)
- 2005** 12. Moved to the present factory enlarged
- 2006** 04. Selected private enterprise to advance abroad(SBC)
Overseas Branch Office Service(KOTRA)
11. Approved clean work place(KOSHA)
- 2007.** 04. Obtained CE certification
Admitted quality management of medical instruments(KTL)
10. Registered products design(KIPO)
- 2008.** 09. Obtained products patent(KIPO)
11. INNOBIZ Confirmation(SMBA)
12. Selected seal of excellence(KOTRA)
- 2009.** 11. Venture Business Confirmation(KIBO)
- 2010.** 04. Selected export support project three years in a row(SMBA)
06. Selected Venture technical innovation and development(SMBA)



DAE YOUNG PRECISION CO.
#44-127, IHYEON-DONG, SEO-GU, DAEGU, KOREA
Tel : 82 . 53 . 525 . 6090~1 Fax : 82 . 53 . 525 . 6092



*We will be the leading company with
our advanced technology and youth in this field*



SUPER SERIES

MICRO MOTOR HANDPIECE POWER UNIT

E mail : daeyoung@dyhandpiece.com / dentalhp@hotmail.com

DAEYOUNG of world-wide inside



DAE YOUNG PRECISION CO.

BLP5 + BLH1

• 60,000 R.P.M



LED Display Box installed

R.P.M is shown in LED display box for easy work.

Various R.P.M control method

R.P.M can be controlled by Hand or Foot/Knee using Hand, Foot/Knee switch.

R.P.M control function for safety

R.P.M can be selected min 0~max 60,000 performance. Can be controlled R.P.M by Foot or Knee within the selected range of R.P.M by dial. It optimizes for safety and operation efficiency. LED display is show the stood R.P.M. It is convenient to operate again in same R.P.M.

AUTO CRUSE function

Keep the selected speed and direction, need not push the Foot/Knee. Useful to work a constant speed.

Self Diagnosis & Reset function

It diagnoses by itself and shows Error Code [E1, E2, E3] in LED box when it is breakdown and malfunction and turn on the Power Switch for reset after the problem solutions.

Basic mode operation set

- Turn on the Power Switch, be set in basis mode.
- R.P.M control: Foot direction [Knee or Foot select]. /-Rotation direction: Forward.
- R.P.M: must select "0" by function of safety.

Low noise, Less vibration

Brushless motor makes low noise and less vibration. It is very useful for the accurate and the detailed work, even this motor can be used semi-permanently.

Excellent Durability

- Using brushless motor that does not make the dust of carbon, bearing can be long used.
- Spindle is specifically designed to does not give the impact on bearing. The bearing has excellent durability and can be long used.

Easy bur exchange type using ball

- Handle can be twisted smoothly due to the installed ball in the inside of handle.
- Handpiece is designed European grip.

Installed special ball bearing

Special ball bearings are installed in handpiece. It brings less heat and low noise for operation. Bearing can be long used.

Strong Torque

- Keep strong Torque on Low and High speed.
- Using sensor-less motor type that reduce troubles on account of broken wires.

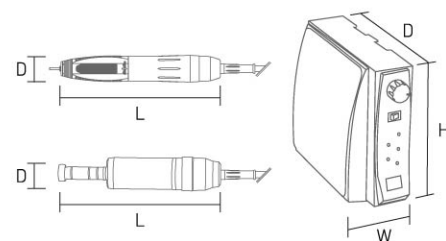

DIMENSION

Model	Width	Length	Height	Weight(g)
SUPER-BLP5	W: 96mm	L: 263mm	H: 230mm	W: 2,500g
Model	Diameter	Length	Weight(g)	
SUPER-BLH1 (60,000R.P.M)	D: Ø25mm	L: 162mm	W: 358g	
SUPER-BLEI	D: Ø24.2mm	L: 122.95mm	W: 325g	

SPECIFICATION

Section	Input	Output	Maximum load current	Consumed Power	Fuse
1	AC110-220V, 50Hz/60Hz				
2	AC115-230V, 50Hz/60Hz	DC 0-34V	230W	80W	110V-115V/4A 220V-240V/2A
3	AC240V,50Hz				

BLP5 + BLH1

• 50,000 R.P.M



LED Display Box installed

R.P.M is shown in LED display box for easy work.

Various R.P.M control method

R.P.M can be controlled by Hand or Foot/Knee using Hand, Foot/Knee switch.

R.P.M control function for safety

R.P.M can be selected min 0~max 50,000 performance. Can be controlled R.P.M by Foot or Knee within the selected range of R.P.M by dial. It optimizes for safety and operation efficiency. LED display is show the stood R.P.M. It is convenient to operate again in same R.P.M.

AUTO CRUSE function

Keep the selected speed and direction, need not push the Foot/Knee. Useful to work a constant speed.

Self Diagnosis & Reset function

It diagnoses by itself and shows Error Code [E1, E2, E3] in LED box when it is breakdown and malfunction and turn on the Power Switch for reset after the problem solutions.

Basic mode operation set

- Turn on the Power Switch, be set in basis mode.
- R.P.M control: Foot direction [Knee or Foot select]. /-Rotation direction: Forward.
- R.P.M: must select "0" by function of safety.

Low noise, Less vibration

Brushless motor makes low noise and less vibration. It is very useful for the accurate and the detailed work, even this motor can be used semi-permanently.

Excellent Durability

- Using brushless motor that does not make the dust of carbon, bearing can be long used.
- Spindle is specifically designed to does not give the impact on bearing. The bearing has excellent durability and can be long used.

Easy bur exchange type using ball

- Handle can be twisted smoothly due to the installed ball in the inside of handle.
- Handpiece is designed European grip.

Installed special ball bearing

Special ball bearings are installed in handpiece. It brings less heat and low noise for operation. Bearing can be long used.

Strong Torque

- Keep strong Torque on Low and High speed.
- Using sensor-less motor type that reduce troubles on account of broken wires.

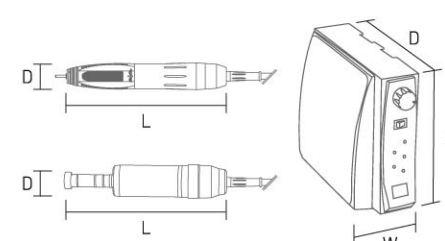

DIMENSION

Model	Width	Length	Height	Weight(g)
SUPER-BLP5	W: 96mm	L: 263mm	H: 230mm	W: 2,500g
Model	Diameter	Length	Weight(g)	
SUPER-BLH1 (50,000R.P.M)	D: Ø25mm	L: 162mm	W: 358g	
SUPER-BLEI	D: Ø24.2mm	L: 122.95mm	W: 325g	

SPECIFICATION

Section	Input	Output	Maximum load current	Consumed Power	Fuse
1	AC110-220V, 50Hz/60Hz				
2	AC115-230V, 50Hz/60Hz	DC 0-34V	230W	80W	110V-115V/4A 220V-240V/2A
3	AC240V,50Hz				

DP5 + NH1 / NH3

40,000 R.P.M

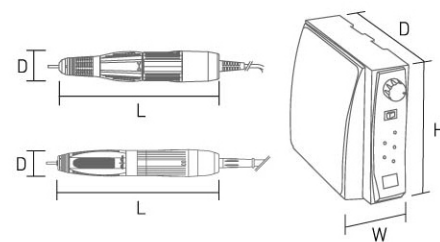

DIMENSION

Model	Width	Length	Height	Weight(g)
SUPER-DP5	W: 96mm	L: 263mm	H: 230mm	W: 2,600g

Model	Diameter	Length	Weight(g)
SUPER-NH1	D: Ø27.2mm	L: 152.5mm	W: 282g
SUPER-NH3	D: Ø27mm	L: 157.7mm	W: 300g

SPECIFICATION

Section	Input	Output	Maximum load current	Consumed Power	Fuse
1	AC110-220V, 50Hz/60Hz	DC 0-32V	148W	70W	110V-115V/4A 220V-240V/2A
2	AC115-230V, 50Hz/60Hz				
3	AC240V, 50Hz				

LED Display Box installed

R.P.M is shown in LED display box for easy work.

Various R.P.M control method

R.P.M(min0~max40,000R.P.M)can be controlled by Hand or Foot/Knee using Hand, Foot/Knee switch.

Self Diagnosis & Reset function

It diagnoses by itself and shows Error Code (ER) in LED box when it is breakdown and malfunction and turn on the Power Switch for reset after the problem solutions.

Feedback function

Provide same power to the handpiece at low speed, so it is offered maximum Torque in all R.P.M.

Excellent durability

Spindle is designed prevent dirt and carbon powder.

Bur exchange

- NH1: Using Cam way. Handle can be twisted easily and exchange burrs easily.
- NH3: Handpiece is designed European grip.
- Handle can be twisted smoothly due to the installed ball in the inside of handle.

Easy bur exchange type using ball

- Handle can be twisted smoothly due to the installed ball in the inside of handle.
- Handpiece is designed European grip.

Installed special ball bearing

Special ball bearings are installed. It brings less heat and low noise for operation. Bearing can be long used.

*Available customized order

Controllable Handpiece & dust collector at same time.
Handpiece speed is proportional to suction force of collector. Handpiece is stop, also collector is stop. It can be saved electricity and solved noise.

NH3

SUPER M 60

SUPER M 1



Milling device

SUPER M 60

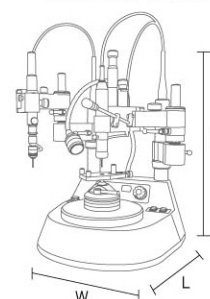

DIMENSION

Model	Width	Length	Height
SUPER-M60	W: 325mm	L: 318mm	H: 420mm

Model	Width	Length	Height
SUPER-M1	W: 200mm	L: 250mm	H: 310mm

SPECIFICATION

Section	Input	Output	Maximum load current	Consumed Power	Fuse
1	AC110-220V, 50Hz/60Hz	DC 0-34V	230W	80W	110V-115V/4A 220V-240V/2A
2	AC115-230V, 50Hz/60Hz				
3	AC240V, 50Hz				

SUPER M 1

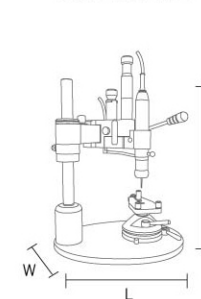

SUPER M 60

Conveniently use because be designed and produced for surveying, hitting tool, milling.

Spring power adjustment

For the adjustment of the vertical movability.

BLDC Micromotor handpiece

- Has the strong power. Use mills, smooths and polishes wax and metal.
- Allows for a rotational speed of up to 60,000rpm.

MT(Milling table) and ST(Survey table)

Special design to consider about work environment. Can be fixed easy in the position and is convenient to use.

LED-lamp

BLDC Micromotor has a built-in LED and another LED. It is possible that Shadow free illumination.

Patented articulated arm lock.

Clamps 2 joints with one screw.

Cost-effective version of a fully professional device

Brushless motor makes low noise and less vibration. It is very useful for the accurate and the detailed work, even this motor can be used semi-permanently.

Excellent Durability

- Keep the best work environment for surveying and milling. On strong and solid vertical column with smooth double-jointed arm.
- Micromotor handpiece head with micrometer screw for accurate adjustment.
- Upgradable to an undercut and surveying machine(optional).
- Quick and easy fixing of the double-joint arm with one hand
- Automatic retraction of the articulated arm via memory function.
- Model table
- M 60-Model table can be magnetically fixed in its position automatically by pressing one button.
- M 1-Model table can be easily controled to fix and to unfix by lever.
- Spring pressure arm resistance for vertical manoeuvrability.

***Option** M 1: BLP6+BLM1(blushless, with a lamp)
DP6+MH1(carbon)

BLP6 + BLH1



Standing type

Useful to work on the top of the workbench.

LED Display Box installed

R.P.M is shown in LED display box for easy work.

Various R.P.M control method

R.P.M can be controlled by Hand or Foot using Hand/Foot switch.

Self Diagnosis & Reset function

R.P.M can be selected 0~50,000 performance. Can be controled R.P.M by Foot within the selected range of R.P.M by dial. It optimizes for safety and operation efficiency. LED display is show the stood R.P.M. It is convenient to operate again in same R.P.M.
*Available customized order 60,000R.P.M

AUTO CRUSE function

Keep the selected speed and direction, need not push the Foot. Useful to work a constant speed.

Self Diagnosis & Reset function

It diagnoses by itself and shows Error Code [E1, E2, E3] in LED box when it is breakdown and malfunction and turn on the Power Switch for reset after the problem solutions.

Basic mode operation set

Turn on the Power Switch, be set in basis mode.

• R.P.M control: Foot direction (Hand and Foot select). / • Rotation direction: Forward.

• R.P.M: must select "0" by function of safety.

Low noise, Less vibration

Brushless motor makes low noise and less vibration. It is very useful for the accurate and the detailed work, even this motor can be used semi-permanently.

Excellent Durability

• Using brushless motor that does not make the dust of carbon, bearing can be long used.

• Spindle is specifically designed to does not give the impact on bearing. The bearing has excellent durability and can be long used.

Easy bur exchange type using ball

• Handle can be twisted smoothly due to the installed ball in the inside of handle.

• Handpiece is designed European grip.

Installed special ball bearing

Special ball bearings are installed in handpiece. It brings less heat and low noise for operation. Bearing can be long used.

Strong Torque

• Keep strong Torque on Low and High speed.

• Using sensor-less motor type that reduce troubles on account of broken wires.

Double handpiece output system

Different bur size(Ø2.34, Ø3) handpiece available.

Install Milling handpiece lamp

When use milling handpiece.

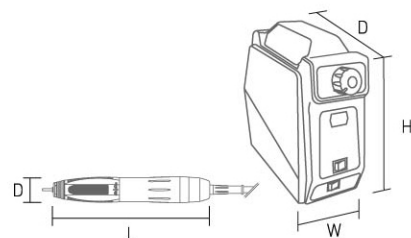

DIMENSION

Model	Width	Length	Height	Weight(g)
SUPER-BLP6	W: 100mm	L: 200mm	H: 200mm	W: 2,500g

Model	Diameter	Length	Weight(g)
SUPER-BLH1	D: Ø25mm	L: 162mm	W: 358g

SPECIFICATION

Section	Input	Output	Maximum load current	Consumed Power	Fuse
1	AC110~220V, 50Hz/60Hz				
2	AC115~230V, 50Hz/60Hz	DC 0~34V	230W	80W	110V~115V/4A 220V~240V/2A
3	AC240V, 50Hz				

DP6 + NH1 / NH3



Standing type

Useful to work on the top of the workbench.

LED Display Box installed

R.P.M is shown in LED display box for easy work.

Various R.P.M control method

R.P.M(min0~max40,000R.P.M)can be controlled by Hand or Foot using Hand/Foot switch.

Self Diagnosis & Reset function

It diagnoses by itself and shows Error Code [ER] in LED box when it is breakdown and malfunction and turn on the Power Switch for reset after the problem solutions.

Feedback function

Provide same power to the handpiece at low speed, so it is offered maximum Torque in all R.P.M.

Excellent durability

Spindle is designed prevent dirt and carbon powder.

Bur exchange

• NH1: Using Cam way. Handle can be twisted easily and exchange burrs easily.

• NH3: Handpiece is designed European grip.

• Handle can be twisted smoothly due to the installed ball in the inside of handle.

Installed special ball bearing

Special ball bearings are installed. It brings less heat and low noise for operation. Bearing can be long used.

Double handpiece output system

• Different bur size(Ø2.34, Ø3) handpiece available.

• Different models (NH1, NH3) handpiece available.

Strong Torque

The best powerful Torque of Carbon motors.

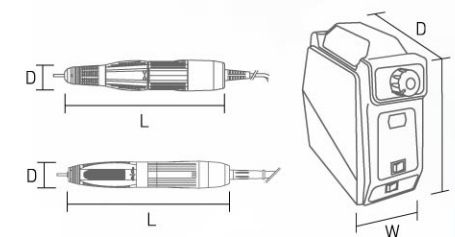

DIMENSION

Model	Width	Length	Height	Weight(g)
SUPER-DP6	W: 100mm	L: 200mm	H: 200mm	W: 2,600g

Model	Diameter	Length	Weight(g)
SUPER-NH1	D: Ø27.2mm	L: 152.5mm	W: 282g
SUPER-NH3	D: Ø27mm	L: 157.7mm	W: 300g

SPECIFICATION

Section	Input	Output	Maximum load current	Consumed Power	Fuse
1	AC110~220V, 50Hz/60Hz				
2	AC115~230V, 50Hz/60Hz	DC 0~32V	146W	70W	110V~115V/4A 220V~240V/2A
3	AC240V, 50Hz				

NP5 + NH1 / NH3

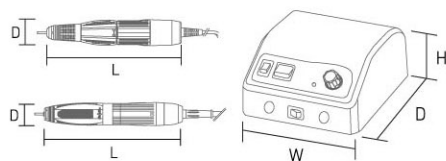

DIMENSION

Model	Width	Length	Height	Weight(g)
SUPER-NP5	W: 149.6mm	L: 171mm	H: 81mm	W: 3,300g
Model	Diameter	Length	Weight(g)	
SUPER-NH1	D: Ø27.2mm	L: 152.5mm	W: 282g	
SUPER-NH3	D: Ø27mm	L: 157.7mm	W: 300g	

SPECIFICATION

Section	Input	Output	Maximum load current	Consumed Power	Fuse
1	AC110-220V, 50Hz/60Hz				
2	AC115-230V, 50Hz/60Hz	DC 0-32V	146W	70W	110V-115V/2A 220V-240V/1A
3	AC240V,50Hz				

Non-stage speed system

R.P.M can be controlled 0~40,000 by Foot pedal and 1,000~40,000 by Hand.
*Available custom order 45,000R.P.M and 50,000R.P.M

Automatic protection system & Reset function

The lamp turns on light and automatically shuts down if it has the breakdown and the malfunction. Turn on the power switch after solutions. It is re-operate.

Feedback function

Provide same power to the handpiece at low speed, so it is offered maximum Torque in all R.P.M.

Double handpiece output system

- Different bur size(Ø2.34, Ø3) handpiece available.
- Different models (NH1, NH3) handpiece available.

Excellent durability

- Spindle is specifically designed preventing dirt and carbon powder and to be lengthened life of bearing.
- Spindle is specifically designed to does not give the impact on bearing. The bearing has excellent durability and can be long used.

Easy bur exchange

- NH1: Using Cam way. Handle can be twisted easily and exchange burrs easily.
- NH3: Handpiece is designed European grip.
- Handle can be twisted smoothly due to the installed ball in the inside of handle.

Installed special ball bearing

Special ball bearings are installed in handpiece. It is bring less heat and low noise for operation. Bearing can be long used.

NP5(S) + NH1 / NH3

NP3 + NH1 / NH2

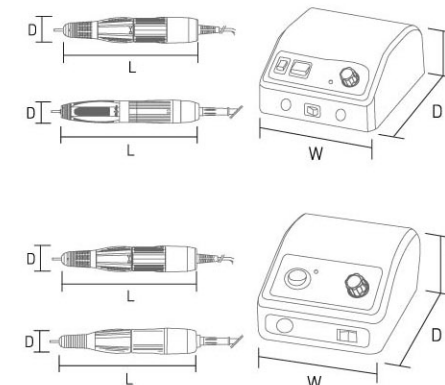

DIMENSION

Model	Width	Length	Height	Weight(g)
SUPER-NP5(S)	W: 149.6mm	L: 171mm	H: 81mm	W: 3,300g
SUPER-NP3	W: 115mm	L: 153mm	H: 76.9mm	W: 1,508g

Model	Diameter	Length	Weight(g)
SUPER-NH1	D: Ø27.2mm	L: 152.5mm	W: 282g

SPECIFICATION

Section	Input	Output	Maximum load current	Consumed Power	Fuse
1	AC110-220V, 50Hz/60Hz				
2	AC115-230V, 50Hz/60Hz	DC 0-32V	NP5(S) 146W	NP5(S) 70W	110V-115V/2A 220V-240V/1A
3	AC240V,50Hz		NP3 99W	NP3 60W	

NP5(S) + NH1 / NH3

Non-stage speed system

R.P.M can be controlled 0~40,000 by Foot pedal and 1,000~40,000 by Hand.

Automatic protection system & Reset function

The lamp turns on light and automatically shuts down if it has the breakdown and the malfunction. Turn on the power switch after solutions. It is re-operate.

Double handpiece output system

- Different bur size(Ø2.34, Ø3) handpiece available.
- Different models (NH1, NH3) handpiece available.

Excellent durability

Spindle is designed prevent dirt and carbon powder.

Easy bur exchange

- NH1: Using Cam way. Handle can be twisted easily and exchange burrs easily.
- NH3: Handpiece is designed European grip.
- Handle can be twisted smoothly due to the installed ball in the inside of handle.

Installed special ball bearing

Special ball bearings are installed. It is bring less heat and low noise for operation. Bearing can be long used.

NP3 + NH1 / NH2

Non-stage speed system

R.P.M can be controlled min0~max35,000 by Foot pedal and by Hand.

Automatic protection system & Reset function

Automatically shuts down if it has the breakdown and the malfunction. Turn on the power switch after solutions. It is re-operate.

Excellent durability

Spindle is designed prevent dirt and carbon powder.

Run on low speed

Handpiece at low speed even is provided power.

Easy bur exchange type using Cam

Handle can be twisted easily and exchange burrs easily.

Installed special ball bearing

Special ball bearings are installed. It is bring less heat and low noise for operation. Bearing can be long used.

NP3(S) + NH2C / NHE

SP2 + NH2



NHE

NP3(S) + NH2C / NHE

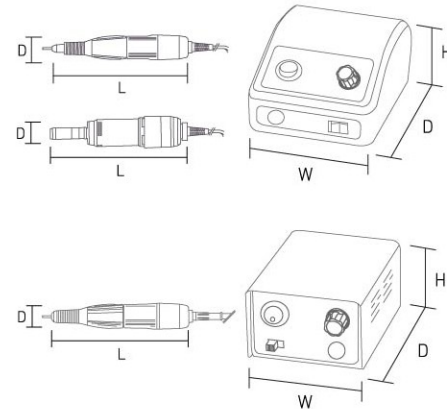

DIMENSION

Model	Width	Length	Height	Weight(g)
SUPER-NP3(S)	W: 115mm	L: 153mm	H: 76.9mm	W: 1,216g
SUPER-SP2	W: 95.8mm	L: 125mm	H: 63.4mm	W: 1,486g

Model	Diameter	Length	Weight(g)
SUPER-NH2C	D: Ø27.2mm	L: 159mm	W: 266g
SUPER-NH2	D: Ø27.2mm	L: 150mm	W: 268g

SPECIFICATION

Section	Input	Output	Maximum load current	Consumed Power	Fuse
1	AC110-220V, 50Hz/60Hz				
2	AC115-230V, 50Hz/60Hz	DC 0-32V	86W	60W	110V-115V/2A 220V-240V/1A
3	AC240V, 50Hz				

ABS case

Power Unit of case is made of ABS, has colorful design.

Non-stage speed system

R.P.M can be controlled min0~max35,000 by Hand and Power switch ON/OFF can be controlled by Foot pedal.

Excellent durability

Spindle is designed prevent dirt and carbon powder.

Easy bur exchange type using Cam

Handle can be twisted easily and exchange burrs easily.

Installed special ball bearing

Special ball bearings are installed. It is bring less heat and low noise for operation. Bearing can be long used.

SP2 + NH2

Steel case

Power Unit of case is made of steel, has small, sturdy design.

Non-stage speed system

R.P.M can be controlled min0~max35,000 by Hand and Power switch ON/OFF can be controlled by Foot pedal.

Excellent durability

Spindle is designed prevent dirt and carbon powder.

Easy bur exchange type using Cam

Handle can be twisted easily and exchange burrs easily.

Installed special ball bearing

Special ball bearings are installed. It is bring less heat and low noise for operation. Bearing can be long used.

NP3 + NHE

SP2 + NHEI



NP3 + NHE

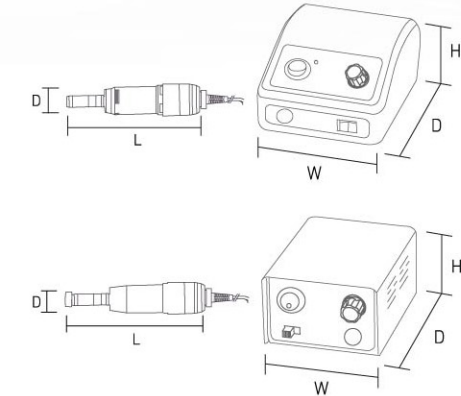

DIMENSION

Model	Width	Length	Height	Weight(g)
SUPER-NP3	W: 115mm	L: 153mm	H: 76.9mm	W: 1,508g
SUPER-SP2	W: 95.8mm	L: 125mm	H: 63.4mm	W: 1,486g
Model	Diameter	Length	Weight(g)	
SUPER-NHE	D: Ø23mm	L: 110mm	W: 186g	
SUPER-NHEI	D: Ø24.8mm	L: 116mm	W: 240g	

SPECIFICATION

Section	Input	Output	Maximum load current	Consumed Power	Fuse
1	AC110-220V, 50Hz/60Hz				
2	AC115-230V, 50Hz/60Hz	DC 0-32V	NP3 95W	60W	110V-115V/2A 220V-240V/1A
3	AC240V, 50Hz		SP2 86W		

Non-stage speed system

R.P.M can be controlled min0~max35,000 by Foot pedal and by Hand.

Automatic protection system & Reset function

Automatically shuts down if it has the breakdown and the malfunction. Turn on the power switch after solutions. It is re-operate.

Excellent durability

Spindle is designed prevent dirt and carbon powder.

E-type handpiece

E-type carbon brush motor, straight or contra angle attachable.

Installed special ball bearing

Special ball bearings are installed. It is bring less heat and low noise for operation. Bearing can be long used.

SP2 + NHEI

Steel case

Power Unit of case is made of steel, has small, sturdy design.

Non-stage speed system

R.P.M can be controlled min0~max35,000 by Hand and Power switch ON/OFF can be controlled by Foot pedal.

Excellent durability

Spindle is designed prevent dirt and carbon powder.

Surgical handpiece

Straight angle and contra angle attachable, water proof and autoclavable. Motor for implant and endo.

Installed special ball bearing

Special ball bearings are installed. It is bring less heat and low noise for operation. Bearing can be long used.

NP3(S) + NHB31 SP2 + NHB30



NP3(S) + NHB31

ABS case

Power Unit of case is made of ABS, has colorful design.

Non-stage speed system

R.P.M can be controlled min0-max30,000 by Hand and Power switch ON/OFF can be controled by Foot pedal.

Compact Design

Hand drill is a light & compact size for nail art, moreover can choose color.

Excellent durability

Spindle is designed prevent dirt and carbon powder.

Easy bur exchange type using Cam

Handle can be twisted easily and exchange burrs easily.

Installed special ball bearing

Special ball bearings are installed. It is bring less heat and low noise for operation. Bearing can be long used.

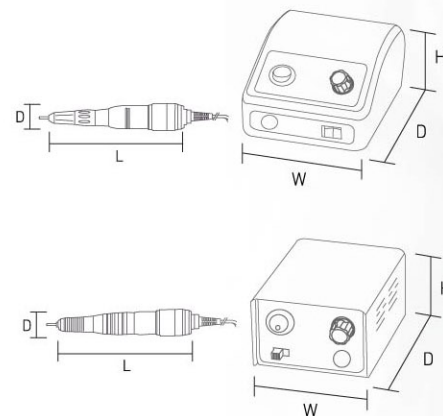

DIMENSION

Model	Width	Length	Height	Weight(g)
SUPER-NP3(S)	W: 115mm	L: 153mm	H: 76.9mm	W: 1,216g
SUPER-SP2	W: 95.8mm	L: 125mm	H: 63.4mm	W: 1,486g
Model	Diameter	Length	Weight(g)	
SUPER-NHB31	D: Ø23mm	L: 132mm	W: 226g	
SUPER-NHB30	D: Ø23mm	L: 133mm	W: 218g	

SPECIFICATION

Section	Input	Output	Maximum load current	Cousumed Power	Fuse
1	AC110-220V, 50Hz/60Hz	DC 0-25V	68W	60W	110V-115V/2A 220V-240V/1A
2	AC115-230V, 50Hz/60Hz				
3	AC240V, 50Hz				

SP2 + NHB30

Steel case

Power Unit of case is made of steel, has small, sturdy design.

Non-stage speed system

R.P.M can be controlled min0-max30,000 by Hand and Power switch ON/OFF can be controled by Foot pedal.

Slim Design

Handpiece has slim design and is a light for nail art.

Excellent durability

Spindle is designed prevent dirt and carbon powder.

Easy bur exchange type using Cam

Handle can be twisted easily and exchange burrs easily.

Installed special ball bearing

Special ball bearings are installed. It is bring less heat and low noise for operation. Bearing can be long used.

BLH1

- Brushless handpiece with no noise and low vibration for excellent performance.
- Using brushless motor that does not make the dust of carbon, bearing can be long used.
- Spindle is specifically designed to do not impact on bearing and to be lengthened life of bearing.
- Handle can be twisted smoothly due to the installed ball in the inside of handle.
- Handpiece is designed European grip.
- Keep strong Torque at Low and High speed.
- Using sensor-less motor type that reduce troubles on account of broken wires.

※ Optional R.P.M

60,000R.P.M-use with power unit BLP5, BLP6

50,000R.P.M-use with power unit BLP5, BLP6

• Optional handpiece color(Gray, Blue)



NH1

- Handpiece with carbon brush for dental laboratory. It is very popular in Asia.
- Special ball bearings for less heat and low noise. Bearing can be long used.
- Excellent durability due to spindle with dust proof design.
- Easy bur exchange type using Cam

※ Optional R.P.M

• 35,000R.P.M - use with all power units for handpiece with carbon brush.

• 40,000R.P.M - suitable to power units NP3, NP5(S), NP5, DP5, DP6

• 45,000R.P.M - recommendable use with power units NP5(S), NP5, DP5, DP6

• 50,000R.P.M - recommendable use with power units NP5(S), NP5, DP5, DP6



NH3

- Handpiece with carbon brush for dental laboratory. It is very popular in U.S.A and Europe.
- Special ball bearings for less heat and low noise. Bearing can be long used.
- Spindle is specifically designed preventing dirt and carbon powder and to be lengthened life of bearing.
- Handle can be twisted smoothly due to the installed ball in the inside of handle.
- Handpiece is designed European grip.

※ Optional R.P.M

• 35,000R.P.M - use with all power units for handpiece with carbon brush.

• 40,000R.P.M - suitable to power units NP3, NP5(S), NP5, DP5, DP6

• 45,000R.P.M - recommendable use with power units NP5(S), NP5, DP5, DP6

• 50,000R.P.M - recommendable use with power units NP5(S), NP5, DP5, DP6

• Optional handpiece color(Gray, Blue)



NH2

- Steel-headed Handpiece with carbon brush for industrial, jewel field and dental laboratory.
- Special ball bearings for less heat and low noise. Bearing can be long used.
- Excellent durability due to spindle with dust proof design.
- Easy bur exchange type using Cam

※ Regular R.P.M

35,000R.P.M - use with all power units for handpiece with carbon brush.



NH2C

- Handpiece attachable contra angle for dental laboratory.
- Special ball bearings for less heat and low noise. Bearing can be long used.
- Excellent durability due to spindle with dust proof design.
- Easy bur exchange type using Cam

※ Regular R.P.M

35,000R.P.M - use with all power units for handpiece with carbon brush.



Super Handpiece

SUPER

NHB31

- Handpiece for nail art, is a light and compact size. Easy to grip.
- Special ball bearings for less heat and low noise. Bearing can be long used.
- Excellent durability due to spindle with dust proof design.
- Handle can be twisted smoothly due to the installed ball in the inside of handle.

※ **Regular R.P.M**
30,000R.P.M - use with power units SP2, NP3(S)
※ **Optional handpiece color**
RED, BLUE, SILVER, KHAKI, BLACK



NHB30

- Handpiece for nail art, is a light and slim size for women.
- Special ball bearings for less heat and low noise. Bearing can be long used.
- Excellent durability due to spindle with dust proof design.
- Easy bur exchange type using Cam.

※ **Regular R.P.M**
30,000R.P.M - use with power units SP2, NP3(S)



BLEI

- Brushless motor makes quite and less vibration.
- Surgical handpiece with brushless for implant/endo motor.
- Straight or contra angle attachable.
- Water proof and autoclavable.
- Keep strong Torque on Low and High speed.
- Using sensor-less motor type that reduce troubles on account of broken wires.

※ **Regular R.P.M**-Use with all power units for handpiece with brushless.



NHE

- E-type carbon brush motor.
- Straight or contra angle attachable.

※ **Regular R.P.M**
35,000R.P.M - use with all power units for handpiece with carbon brush.



NHEI

- Surgical handpiece with carbon brush for implant/endo motor.
- Straight or contra angle attachable.
- Water proof and autoclavable.
- Use for implant and endo.

※ **Regular R.P.M**
35,000R.P.M - use with all power units for handpiece with carbon brush.



NHS1

- Straight angle available with Ø2.34 tool.
- 1:1 Direct Drive
- Max 35,000 R.P.M
- Autoclavable (135°C).



Super Accessory

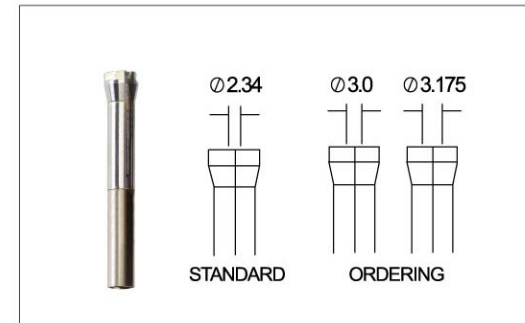

COLLET CHUCK



SPINDLE OF NHB31/NH1/BLH1



ARMATURE / BLH1 MOTOR



CARBON BRUSH



BEARING



BLH1 CORD



COIL CORD / STRAIGHT CORD



NAIL STANDARD / SMALL CORD



EI-TYPE COIL CORD / STRAIGHT CORD



FOOT ON / OFF SWITCH



FOOT SPEED CONTROL

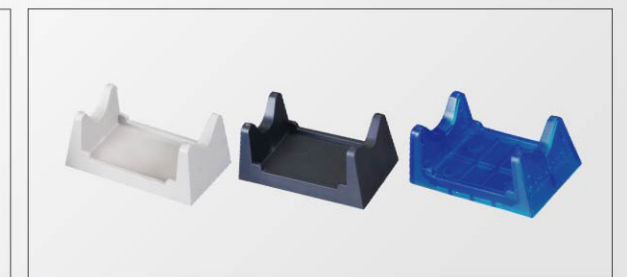

RUBBER STAND

SUPER - NH1, NH2, NH 2C

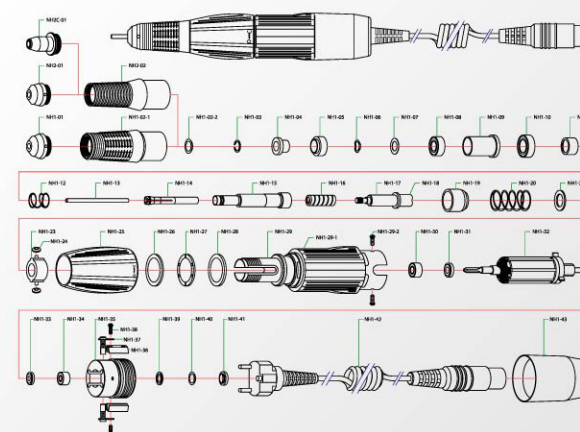

SUPER - BLH1

